

# SPENVIS Standalone

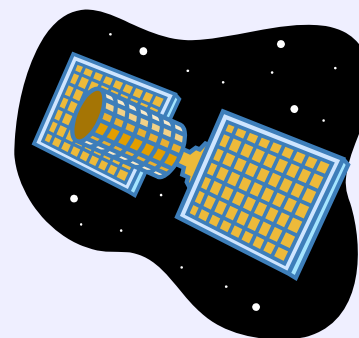

Stijn Calders  
SPENVIS User Workshop 2010  
7 June 2010



# Introduction

- In some circumstances it's difficult to use SPENVIS online, because...
  - company security policy doesn't allow
  - no or slow internet connection available
  - huge calculations are blocked on our server
  - ...
- In these cases SPENVIS standalone could be the solution:
  - Run SPENVIS on your own computer or on a local server



# Presentation outlook

1. Introduction (cont'd)
2. Installation
3. Running SPENVIS
4. Updates



# What is VmWare?

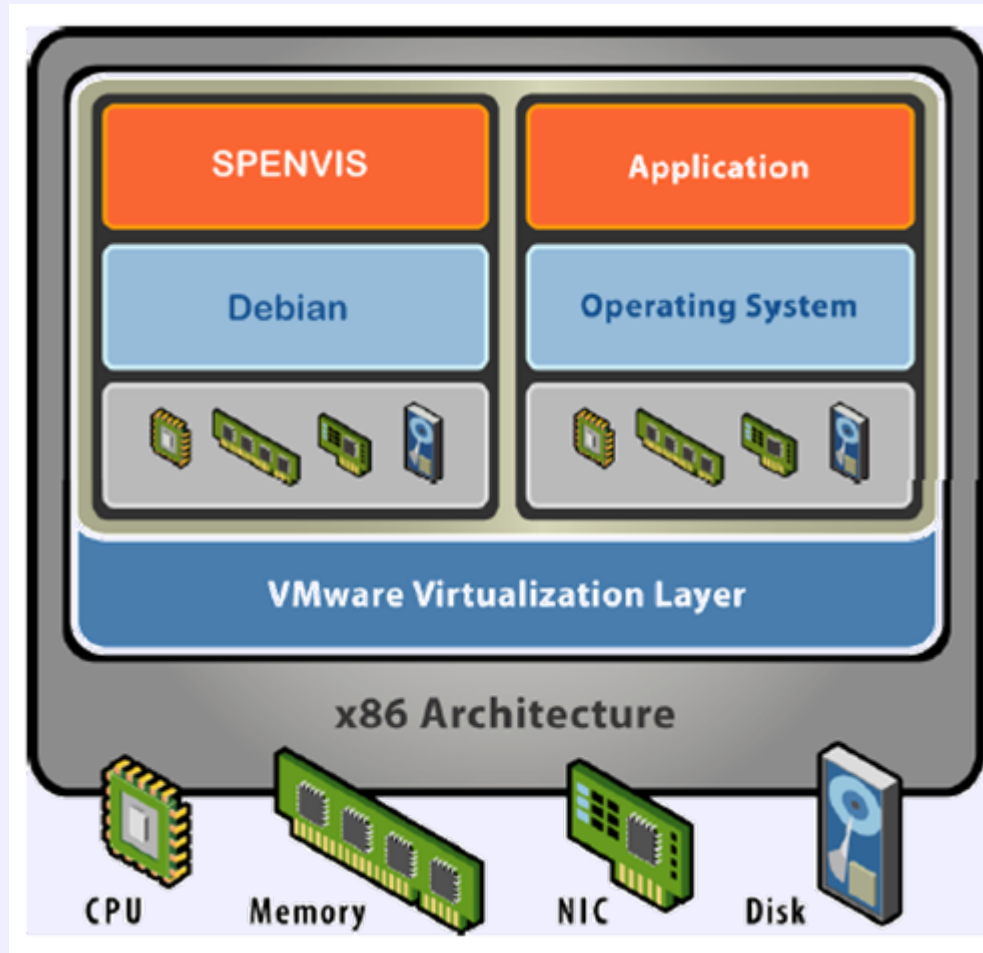

**SPENVIS**  
The Space Environment Information System

# Single vs. multiuser



# Installation (server side)

- Minimal system configuration
  - x86 compatible CPU @ >1.3 GHz
  - 512MB of free memory
  - 8.5GB of free disk space, but can expand to 100GB
- VmWare Player 3.0
  - free for personal non-commercial use
  - available for Windows & Linux
- 2 DVD's
  - First DVD contains a VmWare virtual machine
  - Second DVD contains the SPENVIS installation
- IDL 7.0 runtime license



# Installation (client side)

- Change hosts file
  - E.g. c:\windows\system32\drivers\etc\hosts  
192.168.65.143 [www.spennis-dist.local](http://www.spennis-dist.local)
- If you want to see 3D visualisation:  
Vivaty Player or Octaga Player
- If you want to use the Java Geometry Definition Tool:  
Java Web Start



# Running

- No need to login on the virtual machine

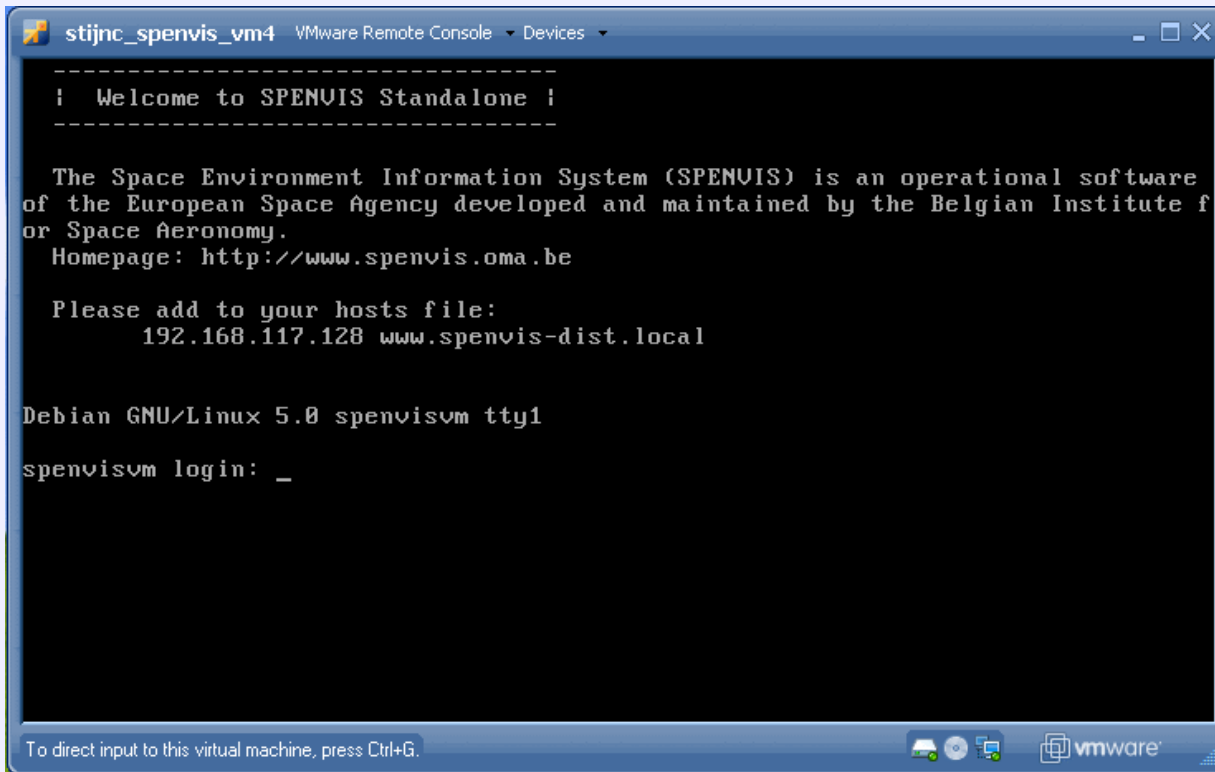

```
stijnc_spenvis_vm4 VMware Remote Console  Devices
-----
| Welcome to SPENVIS Standalone |
-----

The Space Environment Information System (SPENVIS) is an operational software
of the European Space Agency developed and maintained by the Belgian Institute f
or Space Aeronomy.
Homepage: http://www.spenvis.oma.be

Please add to your hosts file:
    192.168.117.128 www.spenvis-dist.local

Debian GNU/Linux 5.0 spenvisvm tty1
spenvisvm login: _
```

To direct input to this virtual machine, press Ctrl+G.



# Running

- Navigate with your web browser to <http://www.spennis-dist.local>

The screenshot displays the SPENVIS web interface. On the left, a navigation menu includes 'Navigation', 'Access', 'Help pages', and 'JGDTool'. The main content area features the 'SPENVIS User's Workshop 2010' header, a description of the system, contact information for Stijn Calders, and a paragraph about the project's initiation by ESA/ESTEC and the Belgian Federal Science Policy Office (Belspo). Overlaid on this is a Mozilla Firefox browser window titled 'Model packages - Mozilla Firefox'. The browser window shows the URL 'http://www.spennis-dist.local/htbin/spennis.exe?%23resettoPrevious/packages.html'. The page content within the browser window includes a dark header with 'SPENVIS Project: TEST', 'Model packages', and 'Planet: Earth', along with 'Output' and 'Help' buttons. Below this is a list of model packages: 'Coordinate generators', 'Radiation sources and effects', 'Spacecraft charging', 'Atmosphere and ionosphere', 'Magnetic field', 'Meteoroids and debris', 'Miscellaneous', 'Geant4 Tools', and 'ECSS Space Environment Standard'. A detailed paragraph explains how models are combined and executed, and another paragraph provides instructions on navigating between model pages. At the bottom of the browser window, there is a footer with '© ESA' and several icons.



aeronomie.be



# Updates

1. Check on <http://www.spennis.oma.be> if updates are available

## My Patches

On this webpage you can manage the patches for your SPENVIS standalone version.

Patch #	Creation date	Status	
1	2010-01-25	Downloadable	<a href="#">Download</a>
2	2010-03-26	Available	<a href="#">Prepare</a>





# Updates

1. Check on <http://www.spervis.oma.be> if updates are available
2. Generate download key on your SPENVIS standalone
3. Download the update with this key

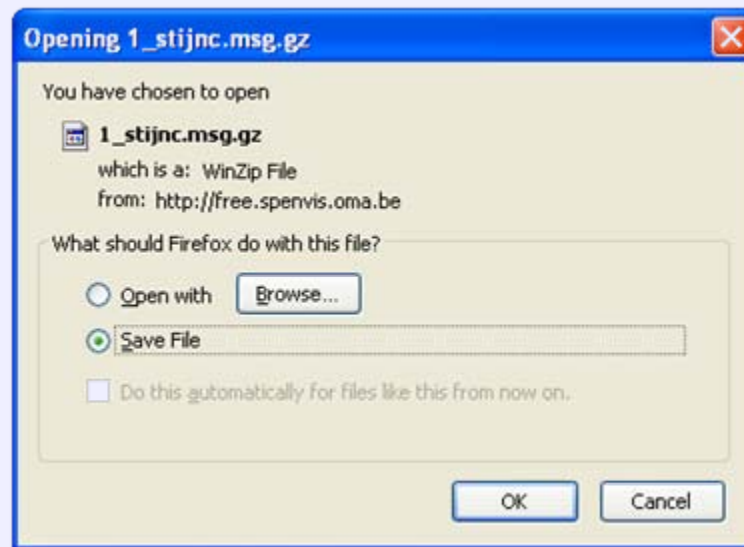

# Updates

1. Check on <http://www.spervis.oma.be> if updates are available
2. Generate download key on your SPENVIS standalone
3. Download the update with this key
4. Install the update through a web interface

## SPENVIS patch - Upload patch

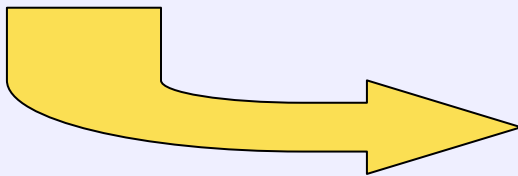

## SPENVIS patch - Install patch

Please wait. Installation is in progress



# Conclusion

- Ideal for lab environments, slow internet connections or heavy calculations
- Thanks to VmWare it's very easy to install
- All models will be available (except ODI databases)



# Questions?

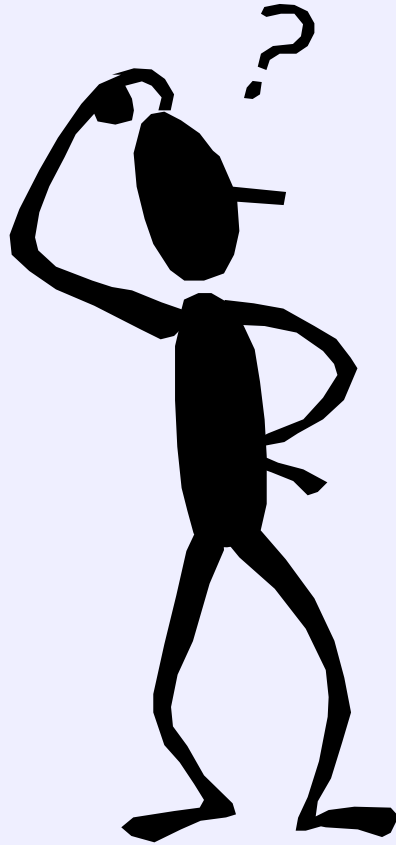

[stijn.calders@aeronomie.be](mailto:stijn.calders@aeronomie.be)



[aeronomie.be](http://aeronomie.be)



[.be](http://.be)